

Congress Programme



Empowering People, Strengthening Networks

**The 9th International Congress
on AIDS in Asia and the Pacific (ICAAP)**

9-13 August 2009

Bali International Convention Centre (BICC)
Nusa Dua, Bali, Indonesia



Congress Programme



Empowering People, Strengthening Networks

**The 9th International Congress on AIDS
in Asia and the Pacific (ICAAP)**

9-13 August 2009, Bali International Convention Centre (BICC)
Nusa Dua, Bali, Indonesia www.icaap9.org



Putu Aikep and Wayan Aikep
welcome all delegates of
the 9th International Congress on AIDS in Asia and the Pacific (ICAAP)
to Bali, Indonesia.

Taking the theme on *Empowering People, Strengthening Networks*, the Congress wishes to envision a vibrant community of empowered people, linked by strong networks that reach across Asia and the Pacific and beyond to mobilize a holistic and effective response, based on the latest best practices and scientific evidence, to the specific and cross-border challenges of the HIV pandemic faced by countries in the region today.

The logo for the 9th ICAAP has originally been developed by Nur Syamsi. The map of the globe represents the Asia-Pacific region, embraced by a network of people working toward a common goal to stop and halt the spread of HIV in the region, represented by the red ribbon in the shape of a person.

This mascots of the 9th ICAAP are named *Wayan* and *Putu*, names which are traditionally given to the first, fifth and/or ninth child in the Balinese family. Both names apply to any gender. Since this is the 'ninth child', we are using those names for our mascots. To make it easier for Indonesians to pronounce "ICAAP", the mascots' second names have been spelled the Indonesian way: *Aikep*. The Mascots are created by Bog-Bog, a Bali-based cartoon magazine.



Bali International Convention Center Map

BICC - GROUND FLOOR DIRECTORY

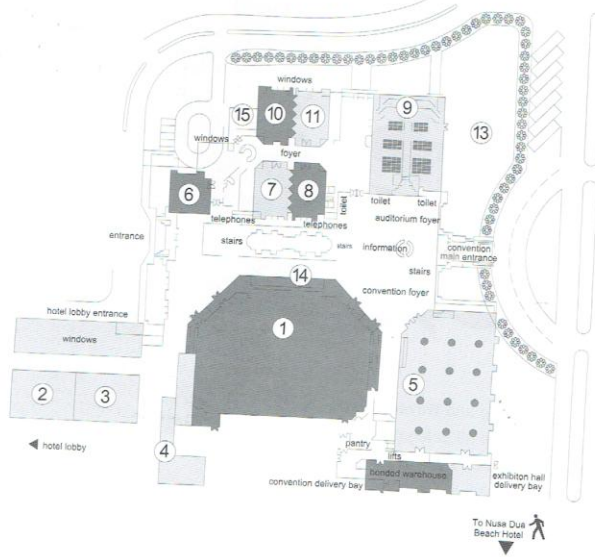

WESTIN LOBBY MAP

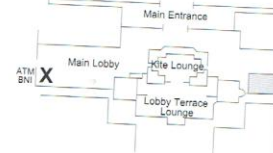

Legend

- 1 Nusa Indah Hall
- 2 Business Center
- 3 Board Room
- 4 Lily & Dahlia
- 5 Exhibition Gallery
- 6 Bali Lounge
- 7 Bougainville
- 8 Orchid
- 9 Auditorium
- 10 Hibiscus
- 11 Frangipani
- 12 Edelweis & Tulip
- 13 Outdoor Exhibition Area
- 14 Indoor Registration Counter
- 15 Flower Secretariat

Room Allocation

No	Room	Allocation
1	Nusa Indah Hall	Plenary Hall
2	Business Centre	Business Centre
3	Board Room	7 Sisters Secretariat
4	Lily & Dahlia	ASAP/IAS Secretariat
5	Exhibition Gallery	Asia Pacific Village
6	Bali Lounge	VVIP & Plenary Speakers Lounge
7	Bougainville	Oral Abstract Session & Satellite Meeting
8	Orchid	Oral Abstract Session & Satellite Meeting
9	Auditorium	Press Conferences & Movies Screening
		Oral Abstract Session & Satellite Meeting
		Community Caucus Space
10	Hibiscus	Oral Abstract Session & Satellite Meeting
11	Frangipani	Oral Abstract Session & Satellite Meeting
12	Edelweis & Tulip	Rapporteurs / Scientific Committee Lounge
13	Outdoor Exhibition Area	Delegates Registration Counter
14	Indoor Registration Counter	Information / Hospitality Desk
15	Flower Secretariat	Medical Centre

BICC - FIRST FLOOR DIRECTORY

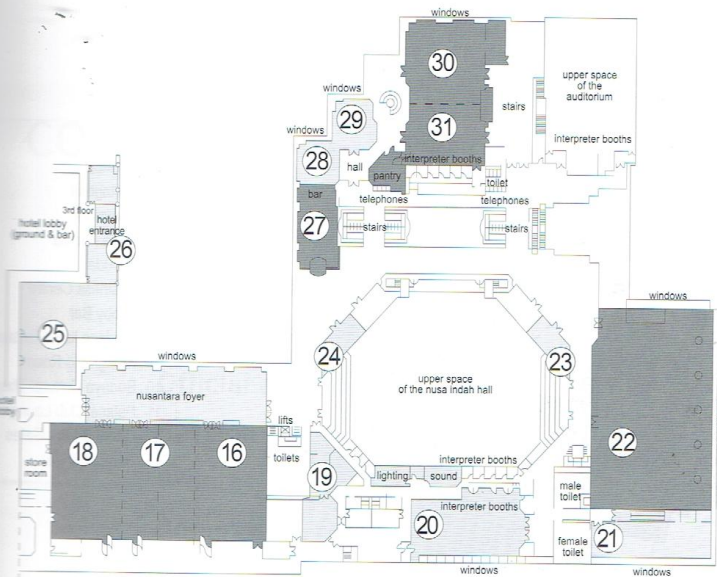

- Legend**
- 16 Nusantara 1
 - 17 Nusantara 2
 - 18 Nusantara 3
 - 19 Denpasar
 - 20 Medan
 - 21 Manado
 - 22 Exhibition Hall
 - 23 Singaraja
 - 24 Karang Asem
 - 25 Heliconia 1 & 2
 - 26 Jasmine & Lotus (3rd Floor)
 - 27 Flamboyant Lounge
 - 28 Bandung
 - 29 Surabaya
 - 30 Jakarta A
 - 31 Jakarta B

Room Allocation

No	Room	Allocation
16	Nusantara I	Oral Abstract Session
		Symposia Session & Satellite Meeting
17	Nusantara II	Oral Abstract Session
		Symposia Session & Satellite Meeting
18	Nusantara III	Oral Abstract Session
		Symposia Session & Satellite Meeting
19	Denpasar	Media Centre
20	Medan	Oral Abstract Session
		Symposia Session & Satellite Meeting
21	Manado	Local Organizing Committee Secretariat
22	Exhibition Hall	Exhibition Hall
23	Singaraja	Scholarship Desk
24	Karang Asem	Speakers Desk & Poster Storage
25	Heliconia 1 & 2	UN Joint Working Space
26	Jasmine & Lotus	PLHIV Lounge
27	Flamboyant Lounge	Internet Cafe
28	Bandung	Skills Building Session & General Meeting Room
29	Surabaya	Skills Building Session & General Meeting Room
30	Jakarta A	Oral Abstract Session
		Symposia Session & Satellite Meeting
31	Jakarta B	Oral Abstract Session
		Symposia Session & Satellite Meeting



Nusa Dua Beach Hotel and Spa

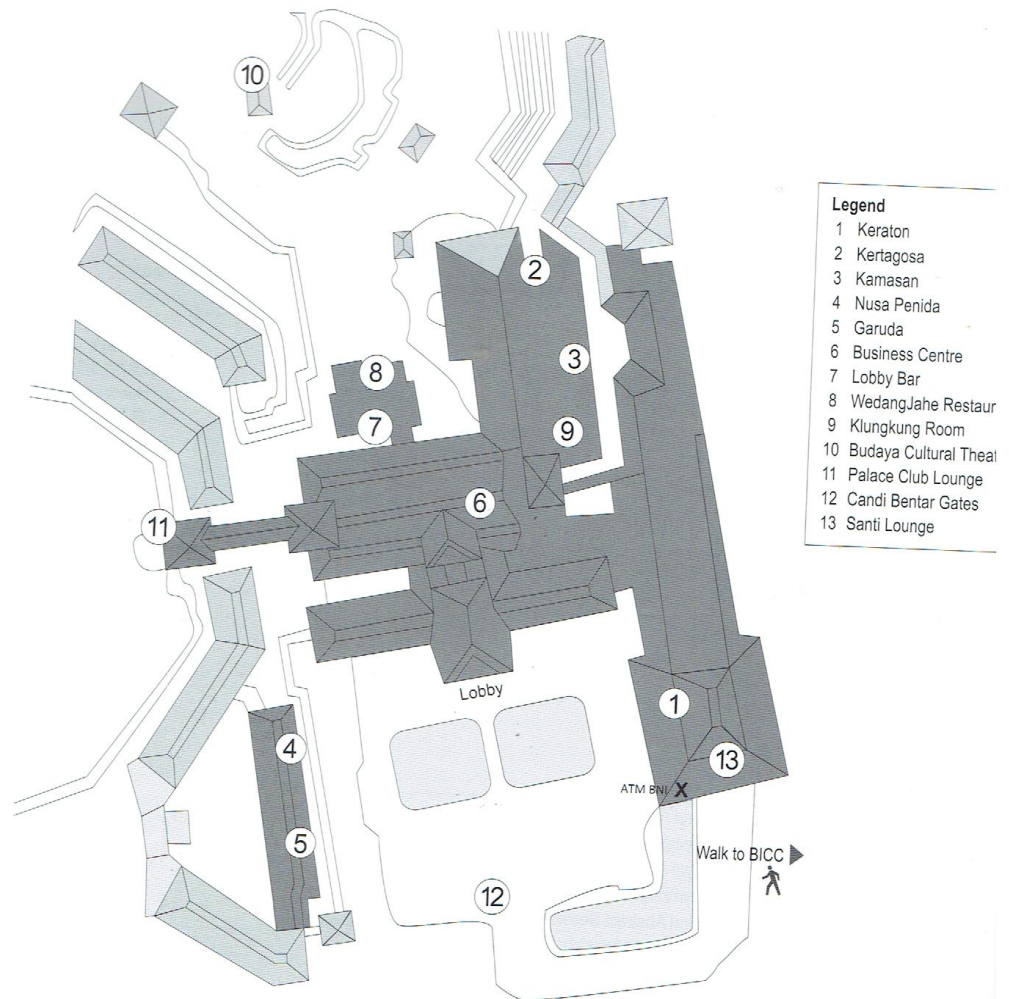

- Legend**
- 1 Keraton
 - 2 Kertagosa
 - 3 Kamasan
 - 4 Nusa Penida
 - 5 Garuda
 - 6 Business Centre
 - 7 Lobby Bar
 - 8 WedangJahe Restaur
 - 9 Klungkung Room
 - 10 Budaya Cultural Theat
 - 11 Palace Club Lounge
 - 12 Candi Bentar Gates
 - 13 Santi Lounge

Room Allocation

No	Room	Allocation
1	Keraton	Skills Building Session & Satellite Meeting
2	Kertagosa	Skills Building Session & Satellite Meeting
3	Kamasan	General Meeting Room
4	Nusa Penida	General Meeting Room
5	Garuda	General Meeting Room
6	Business Centre	Business Centre
7	Lobby Bar	Bar
8	Wedang Jahe Restaurant	Restaurant



CONTENTS

Floor Plan	4
Congress Messages	8
Program Structure	12
Official and Social Programs	13
Session Codes	14
Program at a Glance	16
Congress Organizers	22
Congress Secretariat	24
Information for Speakers and Poster	25
List of Keywords	26
List of Abstract Reviewer	27
Program	28
General Information	132
Acknowledgment	136

WePBO83 Home-Based Care: Bridging the gap of care for People Living with HIV/AIDS (PLHA) in Bandung Indonesia

Keyword: Homecare, Care/support, Nursing care

Kusman Ibrahim, Hartiah Haroen, Barnabas Leuwol, Martiani D. Octavia, Lucas Pinxten

Universitas Padjadjaran, Indonesia

Issues By the year 2015, 11% of the total Indonesia hospital bed capacity is needed for PLHA. To deal with this, home-based care could be a good strategy to deliver health care as well as mobilize and strengthen care resources at family and community level. **Project** : Need assessment to develop a home-based care model for PLHA. Data were gathered through interview and observation with twenty-six PLHA and seven care givers during home visit for 6 months (June-December 2008), and then analyzed qualitatively by using content analysis. **Results** : The family was identified as the main source of support, hope, care, and encouragement. Basic nursing skills such as bathing on bed, wound care, feeding, and universal precaution were needed by family care givers. Medication adherence is one among the major issues that needs to be addressed in the provision of care. Psychosocial-spiritual support and basic information on care for dying and passed-away patients is needed at community and should build on available local resources. **Lesson Learned**: Home-based care service is needed to ensure continuum of care. Health care providers are challenged to strengthen the role of family or care-givers in addressing treatment adherence to be more effective and comprehensive in caring for PLHA.